

FOR LEASE

# PCS KENT



## PROPERTY DETAILS

- 25,848 RSF total
- 11,848 RSF office at \$14.00 PSF, NNN
- Office is move-in ready with great views and natural light
- 14,000 RSF flex at \$0.55 PSF, NNN
- 3 DH and 1 GL : 12-14 ft clear height : Heavy 3 phase power
- Contiguous space
- Plenty of parking
- Immediate access to Green River bike trail

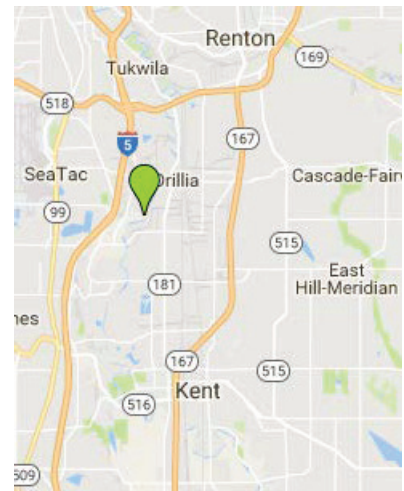

 6004 South 190th St  
Kent, WA 98032

## CONTACT US



### PIETROMONACO PROPERTIES

7900 SE 28th ST, Suite 400  
Mercer Island, WA 98040  
206.607.6020  
[www.pietroprop.com](http://www.pietroprop.com)

### JOHN PIETROMONACO

206.232.7502  
[john@pietroprop.com](mailto:john@pietroprop.com)

### DANNY JACKSON

206.607.6021  
[danny@pietroprop.com](mailto:danny@pietroprop.com)

FOR LEASE  
**PCS KENT**

6004 South 190th St  
Kent, WA 98032

11,848 SF Office space



PIETROMONACO  
PROPERTIES

[www.pietroprop.com](http://www.pietroprop.com)

FOR LEASE  
**PCS KENT**

6004 South 190th St  
Kent, WA 98032

14,000 SF Flex space

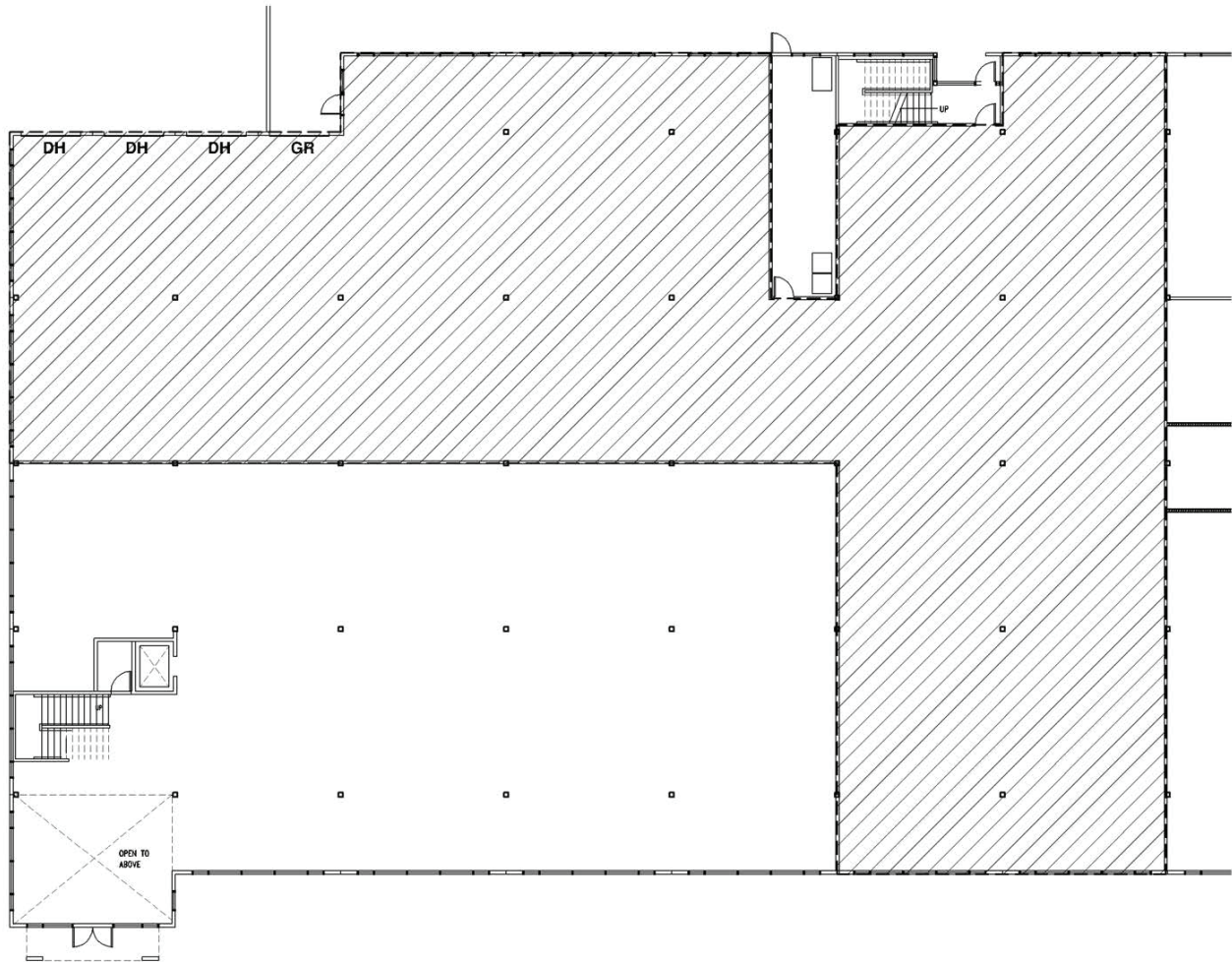

PIETROMONACO  
PROPERTIES

[www.pietroprop.com](http://www.pietroprop.com)